[Home](#)
[Search](#)
[Print](#)
[Previous](#)
[Next](#)

Disclaimer: This information is for tax assessing purposes and is not warranted

Parcel Identification

Map/Lot 0022-112.000
 Account 1656
 State Code 73 - Ex Charter
 Card 1/1
 User Account 40-0050-00

Assessment

Land \$221,400
 Building \$392,500
 Card Total \$613,900
 Parcel Total \$613,900

Prior Assessments

Fiscal Year	Land Value	Building Value	Outbuilding Value	Total Value
2024	\$221,400	\$382,400	\$10,100	\$613,900
2023	\$221,400	\$382,400	\$10,100	\$613,900
2022	\$184,500	\$336,200	\$10,100	\$530,800
2021	\$184,500	\$336,200	\$10,100	\$530,800
2020	\$184,500	\$336,200	\$10,100	\$530,800

Location and Owner

Location 240 ARNOLD RD
 Owner CENTRAL COVENTRY FIRE DISTRICT (TIOGUE)
 Owner2
 Owner3
 Address 240 ARNOLD RD
 Address2
 Address3 COVENTRY RI 02816

Building Information

Design	FireStns
Year Built	1970
Heat	BB Electric
Fireplaces	0
Rooms	0
Bedrooms	0
Bathrooms	2 Full Bath
Above Grade Living Area	6,000 SF

Sale Information

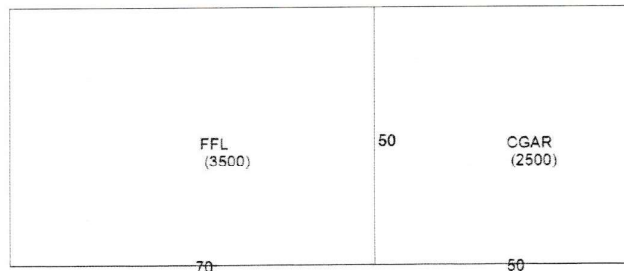
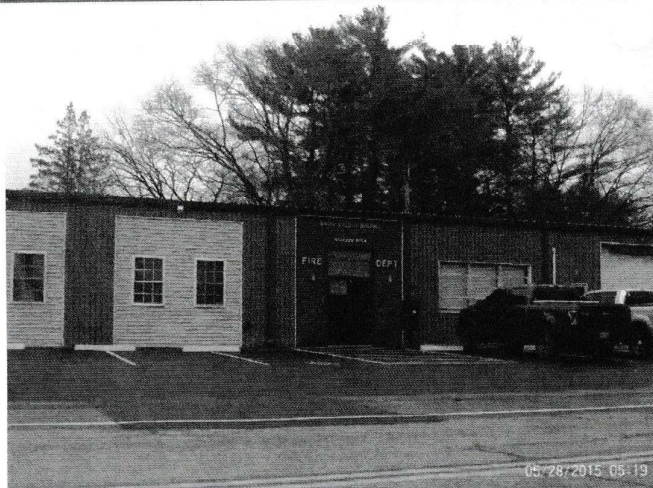

Building Sub Areas

Sub Area	Net Area
1st FLOOR	3,500 SF
COMMERCIAL GARAGE	2,500 SF

Land Information

Land Area 0.55 AC
 Zoning R-20

DISA

iisnode encountered an error when processing the request.

HRESULT: 0x6d
HTTP status: 500
HTTP subStatus: 1013
HTTP reason: Internal Server Error

You are receiving this HTTP 200 response because [system.webServer/iisnode/@devErrorsEnabled](#) configuration setting is 'true'.

In addition to the log of stdout and stderr of the node.exe process, consider using [debugging](#) and [ETW traces](#) to further diagnose the problem.

The last 64k of the output generated by the node.exe process to stderr is shown below:

```
(node:10368) [DEP0005] DeprecationWarning: Buffer() is
(Use `node --trace-deprecation ...` to show where the w
Application has thrown an uncaught exception and is ter
Error: source is not a string
    at Object.module.exports [as parse] (\\axisfiles.aw
    at \\axisfiles.aws.axisgis.com\\share\\axisapi_prod\\A
```

[Click To Open AxisGIS Maps](#)

Fire District
Neighborhood

Central Coventry - (401) 825-7860
2

Yard Item(s)

Description	Quantity	Size	Year
PAVING ASPHALT	1	7000	1970

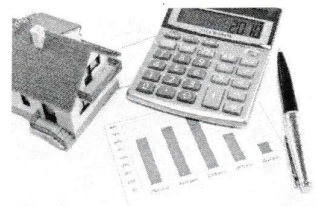
[Home](#)
[Search](#)
[Print](#)
[Previous](#)
[Next](#)

Disclaimer: This information is for tax assessing purposes and is not warranted

Parcel Identification

Map/Lot 0318-005.000
 Account 11492
 State Code 73 - Ex Charter
 Card 1/1
 User Account 40-0010-00

Assessment

Land \$226,600
 Building \$430,700
 Card Total \$657,300
 Parcel Total \$657,300

Prior Assessments

Fiscal Year	Land Value	Building Value	Outbuilding Value	Total Value
2024	\$226,600	\$409,500	\$21,200	\$657,300
2023	\$226,600	\$409,500	\$21,200	\$657,300
2022	\$188,800	\$360,800	\$21,200	\$570,800
2021	\$188,800	\$360,800	\$21,200	\$570,800
2020	\$188,800	\$360,800	\$21,200	\$570,800

Location and Owner

Location 2847 FLAT RIVER RD
 Owner CENTRAL COVENTRY FIRE DISTRICT
 Owner2
 Owner3
 Address 240 ARNOLD RD
 Address2
 Address3 COVENTRY RI 02816

Building Information

Design	FireStns
Year Built	1950
Heat	HW w/A/C
Fireplaces	0
Rooms	0
Bedrooms	0
Bathrooms	2 Full Bath
Above Grade Living Area	4,592 SF

Sale Information

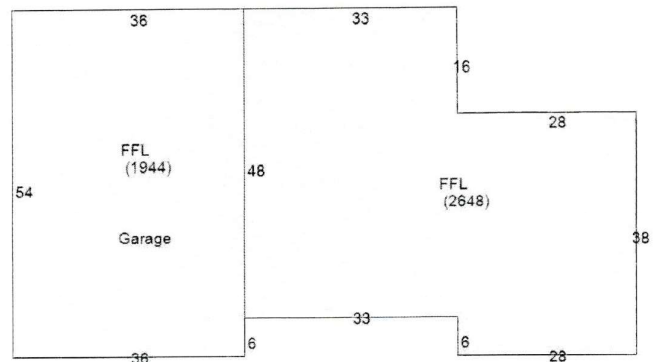

Building Sub Areas

Sub Area
1st FLOOR

Net Area
4,592 SF

Land Information

Land Area 0.86 AC
 Zoning VRC
 Fire District Central Coventry - (401) 825-7860

iisnode encountered an error when processing the request.

HRESULT: 0x6d
HTTP status: 500
HTTP subStatus: 1013
HTTP reason: Internal Server Error

You are receiving this HTTP 200 response because [system.webServer/iisnode/@devErrorsEnabled](#) configuration setting is 'true'.

In addition to the log of stdout and stderr of the node.exe process, consider using [debugging](#) and [ETW traces](#) to further diagnose the problem.

The last 64k of the output generated by the node.exe process to stderr is shown below:

```
(node:3256) [DEP0005] DeprecationWarning: Buffer() is d
(Use `node --trace-deprecation ...` to show where the w
Application has thrown an uncaught exception and is ter
Error: source is not a string
    at Object.module.exports [as parse] (\\axisfiles.aw
    at \\axisfiles.aws.axisgis.com\\share\\axisapi_prod\\A
```

[Click To Open AxisGIS Maps](#)

Neighborhood

3

Yard Item(s)

Description	Quantity	Size	Year
PAVING ASPHALT	1	16000	1968

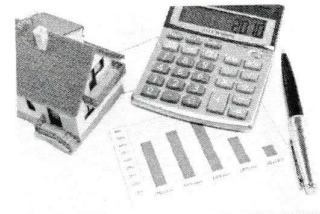
[Home](#)
[Search](#)
[Print](#)
[Previous](#)
[Next](#)

Disclaimer: This information is for tax assessing purposes and is not warranted

Parcel Identification

Map/Lot 0013-031.000
 Account 545
 State Code 73 - Ex Charter
 Card 1/1
 User Account 40-0040-00

Assessment

Land \$102,600
 Building \$453,800
 Card Total \$556,400
 Parcel Total \$556,400

Prior Assessments

Fiscal Year	Land Value	Building Value	Outbuilding Value	Total Value
2024	\$102,600	\$445,600	\$8,200	\$556,400
2023	\$102,600	\$445,600	\$8,200	\$556,400
2022	\$85,500	\$419,200	\$8,200	\$512,900
2021	\$85,500	\$419,200	\$8,200	\$512,900
2020	\$85,500	\$419,200	\$8,200	\$512,900

Location and Owner

Location 1 BESTWICK TRL
 Owner HOPKINS HILL RD FIRE DEPT
 Owner2
 Owner3
 Address 1 BESTWICK TR
 Address2
 Address3 COVENTRY RI 02816

Building Information

Design FireStns
 Year Built 1953
 Heat FWA w/AC
 Fireplaces 0
 Rooms 0
 Bedrooms 0
 Bathrooms 2 Full Bath\ 1 Half Bath
 Above Grade Living Area 3,888 SF

Sale Information

Sale Date	Sale Price	Legal Reference	Instrument
09/27/1988	\$0	76-402	

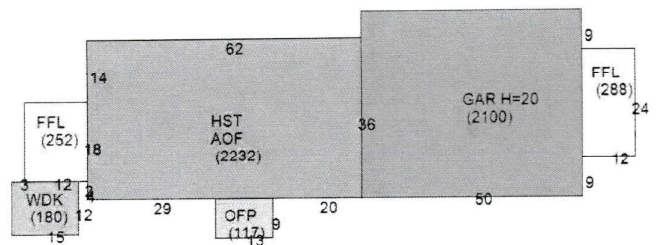

Building Sub Areas

Sub Area	Net Area
1st FLOOR	540 SF
GARAGE	2,100 SF
HALF STORY	1,116 SF
OFFICE AREA	2,232 SF
OPEN PORCH	117 SF
WOOD DECK	180 SF

iisnode encountered an error when processing the request.

HRESULT: 0x6d
HTTP status: 500
HTTP subStatus: 1013
HTTP reason: Internal Server Error

You are receiving this HTTP 200 response because [system.webServer/iisnode/@devErrorsEnabled](#) configuration setting is 'true'.

In addition to the log of stdout and stderr of the node.exe process, consider using [debugging](#) and [ETW traces](#) to further diagnose the problem.

The last 64k of the output generated by the node.exe process to stderr is shown below:

```
(node:5188) [DEP0005] DeprecationWarning: Buffer() is d
(Use `node --trace-deprecation ...` to show where the w
Application has thrown an uncaught exception and is ter
Error: source is not a string
    at Object.module.exports [as parse] (\\axisfiles.aw
    at \\axisfiles.aws.axisgis.com\\share\\axisapi_prod\\A
```

[Click To Open AxisGIS Maps](#)

Land Information

Land Area	0.19 AC
Zoning	R-20
Fire District	Hopkins Hill - (401) 821-1989
Neighborhood	2

Yard Item(s)

Description	Quantity	Size	Year
PAVING ASPHALT	1	4000	1968

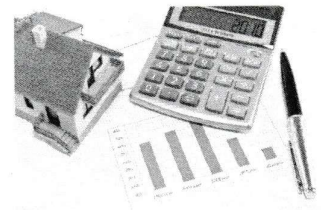
[Home](#)
[Search](#)
[Print](#)
[Previous](#)
[Next](#)

Disclaimer: This information is for tax assessing purposes and is not warranted

Parcel Identification

Map/Lot 0013-032.000
 Account 546
 State Code 73 - Ex Charter
 Card 1/1
 User Account 40-0040-01

Assessment

Land \$151,200
 Building \$57,700
 Card Total \$208,900
 Parcel Total \$208,900

Prior Assessments

Fiscal Year	Land Value	Building Value	Outbuilding Value	Total Value
2024	\$151,200	\$51,800	\$5,900	\$208,900
2023	\$151,200	\$51,800	\$5,900	\$208,900
2022	\$126,000	\$47,900	\$6,100	\$180,000
2021	\$126,000	\$47,900	\$6,100	\$180,000
2020	\$126,000	\$47,900	\$6,100	\$180,000

Location and Owner

Location 0 HOPKINS HILL RD
 Owner HOPKINS HILL RD FIRE DEPT
 Owner2
 Owner3
 Address 1 BESTWICK TR
 Address2
 Address3 COVENTRY RI 02816

Building Information

Design	Gar Rpr
Year Built	1998
Heat	Forced Air
Fireplaces	0
Rooms	0
Bedrooms	0
Bathrooms	2 Half Bath
Above Grade Living Area	1,036 SF

Sale Information

Sale Date	Sale Price	Legal Reference	Instrument
08/06/1982	\$0	142-676	

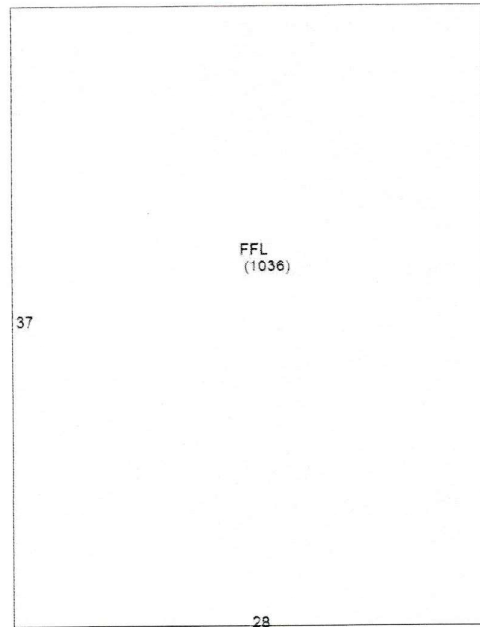

Building Sub Areas

Sub Area	Net Area
1st FLOOR	1,036 SF

Land Information

Land Area	0.28 AC
Zoning	R-20
Fire District	Hopkins Hill - (401) 821-1989

iisnode encountered an error when processing the request.

HRESULT: 0x6d
HTTP status: 500
HTTP subStatus: 1013
HTTP reason: Internal Server Error

You are receiving this HTTP 200 response because [system.webServer/iisnode/@devErrorsEnabled](#) configuration setting is 'true'.

In addition to the log of stdout and stderr of the node.exe process, consider using [debugging](#) and [ETW traces](#) to further diagnose the problem.

The last 64k of the output generated by the node.exe process to stderr is shown below:

```
(node:9508) [DEP0005] DeprecationWarning: Buffer() is d
(Use 'node --trace-deprecation ...' to show where the w
Application has thrown an uncaught exception and is ter
Error: source is not a string
    at Object.module.exports [as parse] (\\axisfiles.aw
    at \\axisfiles.aws.axisgis.com\\share\\axisapi_prod\\A
```

[Click To Open AxisGIS Maps](#)

Neighborhood

2

Yard Item(s)

Description	Quantity	Size	Year
PAVING ASPHALT	1	2000	1998

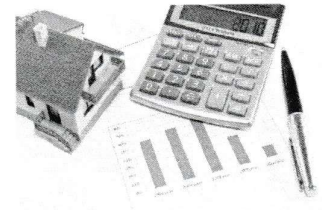
[Home](#)
[Search](#)
[Print](#)
[Previous](#)
[Next](#)

Disclaimer: This information is for tax assessing purposes and is not warranted

Parcel Identification

Map/Lot 0055-038.000
 Account 5625
 State Code 73 - Ex Charter
 Card 1/1
 User Account 40-0020-00

Assessment

Land \$177,600
 Building \$821,400
 Card Total \$999,000
 Parcel Total \$999,000

Prior Assessments

Fiscal Year	Land Value	Building Value	Outbuilding Value	Total Value
2024	\$177,600	\$791,400	\$30,000	\$999,000
2023	\$177,600	\$791,400	\$30,000	\$999,000
2022	\$148,000	\$696,100	\$28,700	\$872,800
2021	\$148,000	\$696,100	\$28,700	\$872,800
2020	\$148,000	\$696,100	\$28,700	\$872,800

Location and Owner

Location 571 WASHINGTON ST
 Owner COVENTRY FIRE DISTRICT
 Owner2 ANTHONY FIRE STATION
 Owner3
 Address 571 WASHINGTON ST
 Address2
 Address3 COVENTRY RI 02816

Building Information

Design FireStns
 Year Built 1925
 Heat FWA w/AC
 Fireplaces 0
 Rooms 0
 Bedrooms 0
 Bathrooms 1 Full Bath\ 2 Half Bath
 Above Grade Living Area 8,627 SF

Sale Information

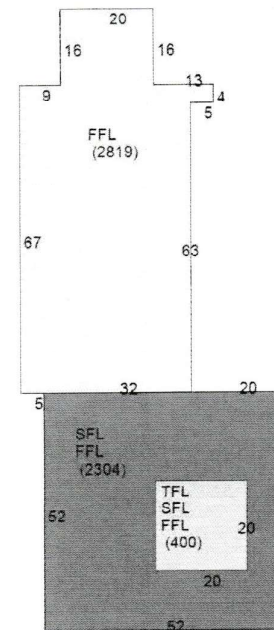
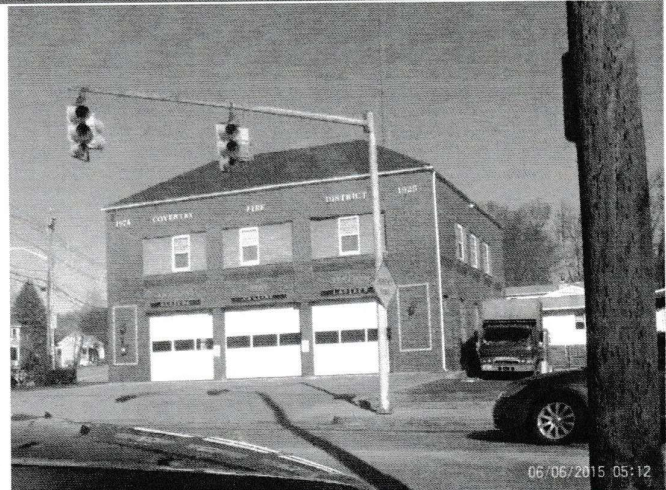

Building Sub Areas

Sub Area	Net Area
1st FLOOR	5,523 SF
2nd FLOOR	2,704 SF
3rd FLOOR	400 SF

Land Information

Land Area 0.37 AC



iisnode encountered an error when processing the request.

HRESULT: 0x6d
HTTP status: 500
HTTP subStatus: 1013
HTTP reason: Internal Server Error

You are receiving this HTTP 200 response because [system.webServer/iisnode/@devErrorsEnabled](#) configuration setting is 'true'.

In addition to the log of stdout and stderr of the node.exe process, consider using [debugging](#) and [ETW traces](#) to further diagnose the problem.

The last 64k of the output generated by the node.exe process to stderr is shown below:

```
(node:8992) [DEP0005] DeprecationWarning: Buffer() is d
(Use `node --trace-deprecation ...` to show where the w
Application has thrown an uncaught exception and is ter
Error: source is not a string
    at Object.module.exports [as parse] (\\axisfiles.aw
    at \\axisfiles.aws.axisgis.com\\share\\axisapi_prod\\A
```

[Click To Open AxisGIS Maps](#)

Zoning	
Fire District	Coventry (Anthony) - (401) 821-3141
Neighborhood	3

Yard Item(s)

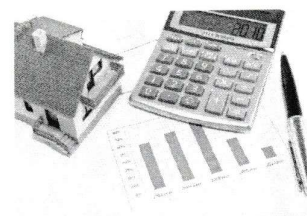
[Home](#)
[Search](#)
[Print](#)
[Previous](#)
[Next](#)

Disclaimer: This information is for tax assessing purposes and is not warranted

Parcel Identification

Map/Lot 0316-059.007
 Account 11230
 State Code 73 - Ex Charter
 Card 1/1
 User Account 40-0060-00

Assessment

Land \$817,900
 Building \$1,145,500
 Card Total \$1,963,400
 Parcel Total \$1,963,400

Prior Assessments

Fiscal Year	Land Value	Building Value	Outbuilding Value	Total Value
2024	\$817,900	\$1,122,400	\$23,100	\$1,963,400
2023	\$817,900	\$1,122,400	\$23,100	\$1,963,400
2022	\$681,600	\$1,025,000	\$39,800	\$1,746,400
2021	\$681,600	\$1,025,000	\$39,800	\$1,746,400
2020	\$681,600	\$1,025,000	\$39,800	\$1,746,400

Location and Owner

Location 1110 VICTORY HWY
 Owner WESTERN COVENTRY FIRE DISTRICT
 Owner2
 Owner3
 Address 1110 VICTORY HIGHWAY
 Address2
 Address3 GREENE RI 02827

Building Information

Design FireStns
 Year Built 2008
 Heat FWA w/AC
 Fireplaces 0
 Rooms 0
 Bedrooms 0
 Bathrooms 3 Full Bath\ 2 Half Bath
 Above Grade Living Area 8,260 SF

Sale Information

Sale Date	Sale Price	Legal Reference	Instrument
03/19/1999	\$126,000	784-126	

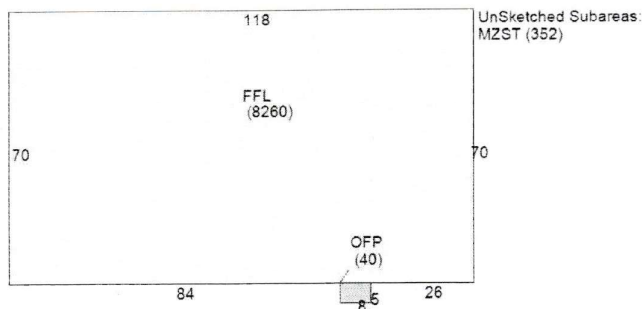

Building Sub Areas

Sub Area	Net Area
1st FLOOR	8,260 SF
MEZZANINE - STORAGE	352 SF
OPEN PORCH	40 SF

Land Information

Land Area 6.02 AC

iisnode encountered an error when processing the request.

HRESULT: 0x6d
HTTP status: 500
HTTP subStatus: 1013
HTTP reason: Internal Server Error

You are receiving this HTTP 200 response because
[system.webServer/iisnode/@devErrorsEnabled](#)
configuration setting is 'true'.

In addition to the log of stdout and stderr of the node.exe
process, consider using [debugging](#) and [ETW traces](#) to
further diagnose the problem.

The last 64k of the output generated by the node.exe
process to stderr is shown below:

```
(node:8488) [DEP0005] DeprecationWarning: Buffer() is d
(Use 'node --trace-deprecation ...' to show where the w
Application has thrown an uncaught exception and is ter
Error: source is not a string
    at Object.module.exports [as parse] (\\axisfiles.aw
    at \\axisfiles.aws.axisgis.com\\share\\axisapi_prod\\A
```

[Click To Open AxisGIS Maps](#)

Zoning
Fire District
Neighborhood

R-3A
Western Coventry - (401) 397-5916
3

Yard Item(s)

Description	Quantity	Size	Year
PAVING ASPHALT	1	10000	2008
SIGN W/INTERIOR LIGHTS	2	32	2008

CATALIS[®]

Coventry, RI

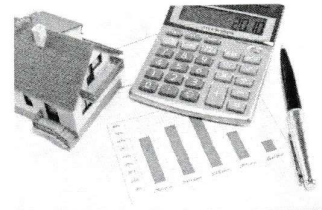
[Home](#)
[Search](#)
[Print](#)
[Previous](#)
[Next](#)

Disclaimer: This information is for tax assessing purposes and is not warranted

Parcel Identification

Map/Lot 0314-048.000
 Account 10993
 State Code 73 - Ex Charter
 Card 1/1
 User Account 40-0060-00

Assessment

Land \$137,800
 Building \$246,500
 Card Total \$384,300
 Parcel Total \$384,300

Prior Assessments

Fiscal Year	Land Value	Building Value	Outbuilding Value	Total Value
2024	\$137,800	\$231,500	\$15,000	\$384,300
2023	\$137,800	\$231,500	\$15,000	\$384,300
2022	\$113,200	\$202,800	\$14,100	\$330,100
2021	\$113,200	\$202,800	\$14,100	\$330,100
2020	\$113,200	\$202,800	\$14,100	\$330,100

Location and Owner

Location 2 HOPKINS HOLLOW RD
 Owner WESTERN COVENTRY FIRE DISTRICT
 Owner2
 Owner3
 Address 1110 VICTORY HIGHWAY
 Address2
 Address3 GREENE RI 02827

Building Information

Design	FireStns
Year Built	1940
Heat	Forced Air
Fireplaces	0
Rooms	0
Bedrooms	0
Bathrooms	1 Half Bath
Above Grade Living Area	2,048 SF

Sale Information

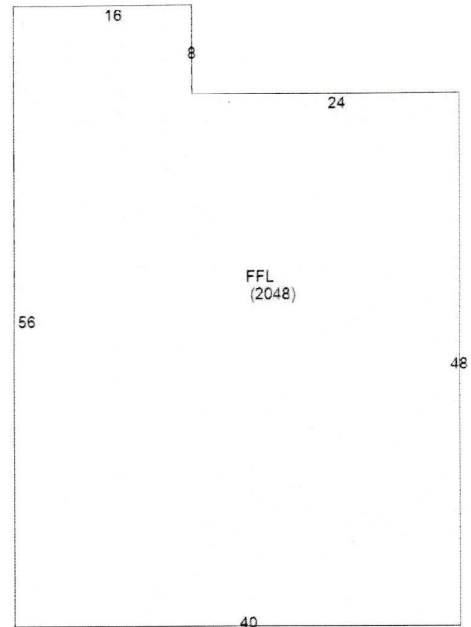
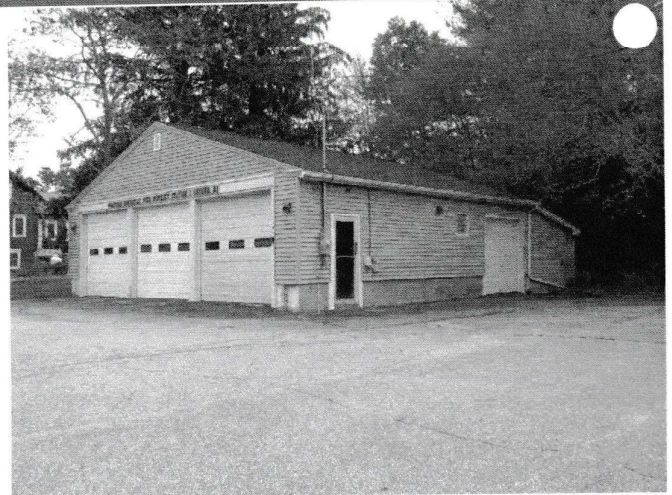

Building Sub Areas

Sub Area
1st FLOOR

Net Area
2,048 SF

Land Information

Land Area 0.96 AC
 Zoning R-5A
 Fire District Western Coventry - (401) 397-5916

DISA

iisnode encountered an error when processing the request.

HRESULT: 0x6d
HTTP status: 500
HTTP subStatus: 1013
HTTP reason: Internal Server Error

You are receiving this HTTP 200 response because [system.webServer/iisnode/@devErrorsEnabled](#) configuration setting is 'true'.

In addition to the log of stdout and stderr of the node.exe process, consider using [debugging](#) and [ETW traces](#) to further diagnose the problem.

The last 64k of the output generated by the node.exe process to stderr is shown below:

```
(node:4504) [DEP0005] DeprecationWarning: Buffer() is d
(Use `node --trace-deprecation ...` to show where the w
Application has thrown an uncaught exception and is ter
Error: source is not a string
    at Object.module.exports [as parse] (\\axisfiles.aw
    at \\axisfiles.aws.axisgis.com\\share\\axisapi_prod\\A
```

[Click To Open AxisGIS Maps](#)

Neighborhood

4

Yard Item(s)

Description	Quantity	Size	Year
GARAGE	1	540	1968
PAVING ASPHALT	1	2400	1940